



**PROVENCE**  
by Blue Mountain Communities

## Expand Your Horizons Right At Home

The community of Provence offers an artful blend of location, convenience, and variety. Our townhomes are perfect for individuals and families who love the city, but also value the comforts of their own home.

Provence embodies the possibility of enjoying a beautiful home with a convenient urban location at a great value. Located in the Natomas neighborhood of Sacramento it offers all this and more. Open floor plans, packed with features, were designed to suit today's lifestyle while the curated architecture lends to its aesthetic appeal.

Provence's convenient location provides community amenities right outside your front door, including a pool and walkable shopping and restaurants. The Natomas area is renowned for highly acclaimed schools, a strong sense of community, and more parks than any other part of Sacramento. It is also near some of the best career opportunities in Northern California – from high tech, to government, to healthcare.

Living here you will discover that there is never a shortage of things to do, see, and explore.

The booming Sacramento Metro Area is home to such attractions as the Golden One Entertainment Center, historic Old Sacramento; the California State Capitol Museum; the Sacramento Zoo, and much more.

From a splendid array of parks, dining, and shopping to some of California's top attractions, you'll be right in the center of it all.

Call (916) 496-4074 or  
text (916) 936-5516  
[provence@bluemountaincommunities.com](mailto:provence@bluemountaincommunities.com)

**BLUE MOUNTAIN**  
COMMUNITIES

## RESIDENCE FEATURES AND DETAILS

### BLUE MOUNTAIN CUSTOMER CARE PACKAGE

- Builder 1-year fit and finish warranty
- 2-10 Homebuyer Warranty
- Buyer Frame Walk
- Buyer Touch-up Walk
- New Homeowner Orientation
- 30-day Customer Care Follow-up Visit

### DISTINCTIVE EXTERIORS

- Beautifully durable tile roofs
- Garage door with opener
- Designer selected exterior color schemes
- August video doorbell

### THOUGHTFUL INTERIORS

- Stylish 2-panel style interior door
- Laminate Vinyl Plank and plush designer carpeting throughout
- Convenient interior laundry rooms with gas dryer hook ups
- 9 foot ceilings
- 3 ¼ inch Colonial baseboards
- Chrome lever door handles

### GOURMET KITCHENS

- Chrome Moen pull-out faucet
- Dal-tile granite countertops with three exceptional colors to choose from
- Your choice of four beautiful cabinet stain colors
- Stainless steel sink with waste disposal system
- Refrigerator area plumbed for ice maker
- Stainless steel GE appliance package including self-cleaning gas range, microwave range hood, and multi-cycle dishwasher

### ENERGY CONSERVATION

- Energy efficient tankless water heater
- Vinyl dual pane windows with low-e glass
- All homes meet or exceed Title-24 energy requirements
- Water conserving shower heads, faucets, and toilets

### PRIVATE MASTER SUITES

- Exquisite Moen chrome faucets and plumbing fixtures
- Chrome shower enclosures
- Full width vanity mirror
- Glamorous E-Stone on vanities and master shower
- Thoughtfully selected vanity lights

### SECONDARY BATHROOMS

- Easy maintenance shower/tub surrounds
- Beautiful E-Stone countertops
- Moen chrome faucets and plumbing fixtures
- Full vanity width mirror

### PERSONALIZING OPPORTUNITIES

- Nest E thermostat
- Upgrade cabinets to a beautifully selected paint grade color
- Upgraded appliance packages
- Numerous electrical and plumbing fixture upgrades
- Innovative security system
- Lighting fixture upgrades throughout the home
- Upgraded interior door options
- Upgraded frame bath vanity mirror
- Opportunity to select upgrade packages for countertops, surrounds, and flooring







BUILDING ONE | SPANISH STYLE  
RESIDENCE A | RESIDENCE B | RESIDENCE B | RESIDENCE A



BUILDING FIVE | TUSCAN STYLE  
RESIDENCE A | RESIDENCE B | RESIDENCE B | RESIDENCE A



In a continuous effort to improve our product, Blue Mountain reserves the right to make changes or modifications to pricing, standard features, options & other building specifications & dimensions without prior notice. Please see sales representative for details. Square footage is approximate based upon design. 08.22.19

**BLUE MOUNTAIN**  
COMMUNITIES



PROVENCE  
by Blue Mountain Communities

# RESIDENCE A

1,394 square feet | 3 Bedrooms | 2.5 Baths | 2 Car Garage



FIRST FLOOR

SECOND FLOOR



In a continuous effort to improve our product, Blue Mountain reserves the right to make changes or modifications to pricing, standard features, options & other building specifications & dimensions without prior notice. Please see sales representative for details. Square footage is approximate based upon design. 08.22.19

BLUE MOUNTAIN  
COMMUNITIES





BUILDING TWO | SPANISH STYLE  
RESIDENCE A | RESIDENCE B | RESIDENCE C | RESIDENCE C



BUILDING SIX | TUSCAN STYLE  
RESIDENCE A | RESIDENCE B | RESIDENCE C | RESIDENCE C



In a continuous effort to improve our product, Blue Mountain reserves the right to make changes or modifications to pricing, standard features, options & other building specifications & dimensions without prior notice. Please see sales representative for details. Square footage is approximate based upon design. 08.22.19

BLUE MOUNTAIN  
COMMUNITIES

# RESIDENCE B

1,920 square feet | 4 - 5 Bedrooms | 3.5 Baths | 2 Car Garage

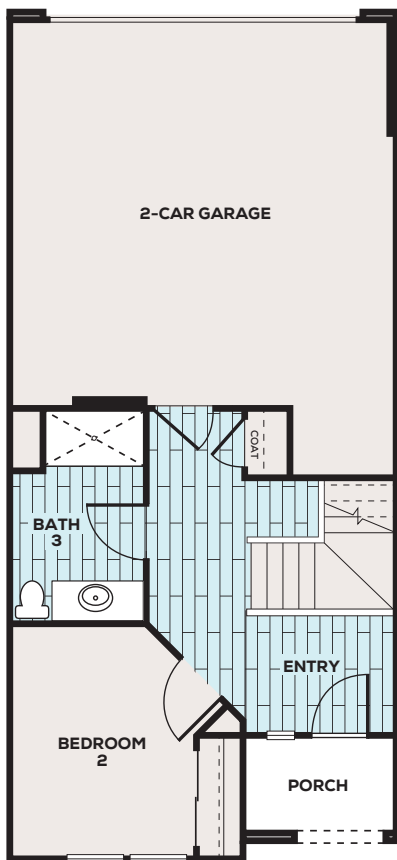

FIRST FLOOR

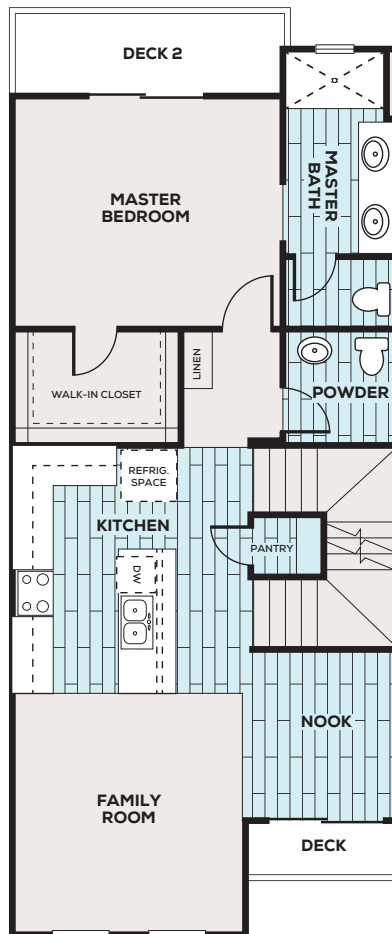

SECOND FLOOR

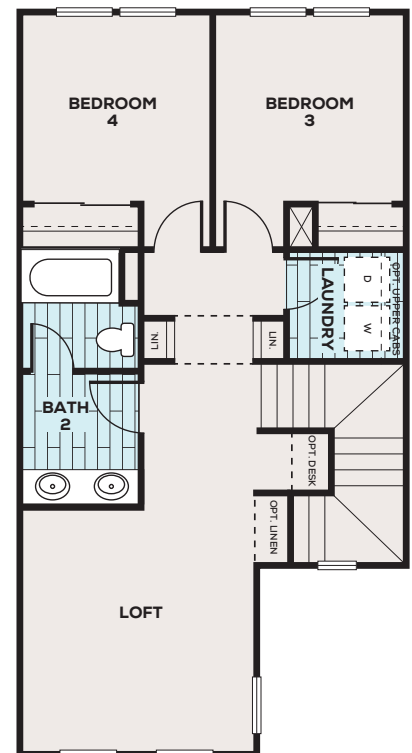

THIRD FLOOR

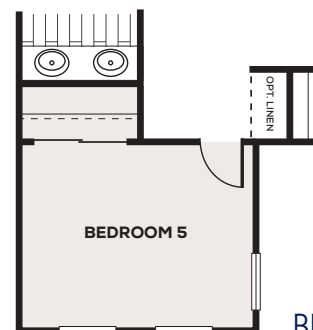

OPTIONAL  
BEDROOM 5







BUILDING THREE | SPANISH STYLE  
RESIDENCE A | RESIDENCE B | RESIDENCE C | RESIDENCE B | RESIDENCE A



BUILDING SEVEN | TUSCAN STYLE  
RESIDENCE A | RESIDENCE B | RESIDENCE C | RESIDENCE B | RESIDENCE A



In a continuous effort to improve our product, Blue Mountain reserves the right to make changes or modifications to pricing, standard features, options & other building specifications & dimensions without prior notice. Please see sales representative for details. Square footage is approximate based upon design. 08.22.19

BLUE MOUNTAIN  
COMMUNITIES



PROVENCE  
by Blue Mountain Communities

# RESIDENCE C

2,298 square feet (Spanish) | 2,242 square feet  
(Tuscan) 4 Bedrooms | 3.5 Baths | 2 Car Garage

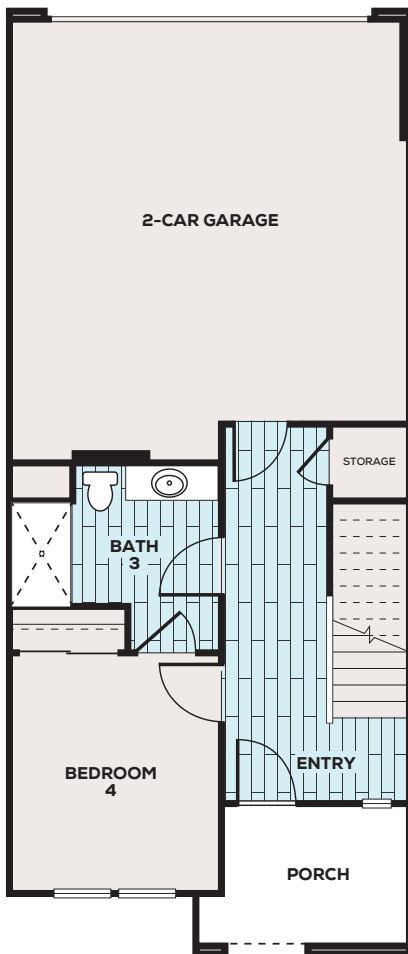

FIRST FLOOR

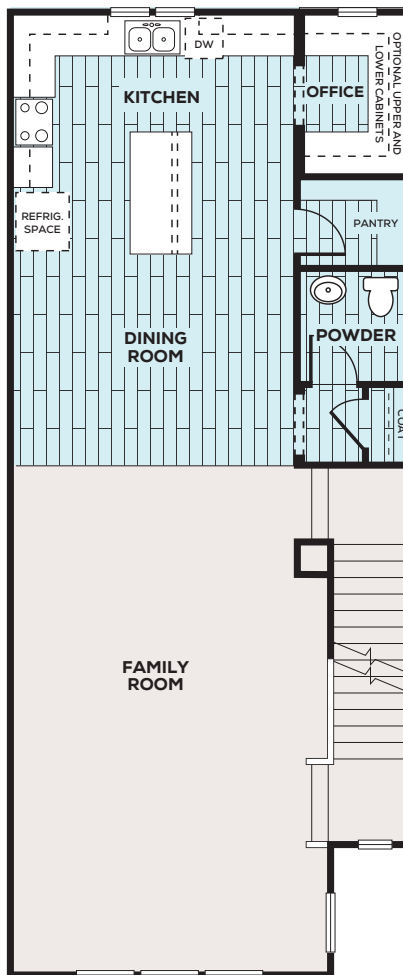

SECOND FLOOR

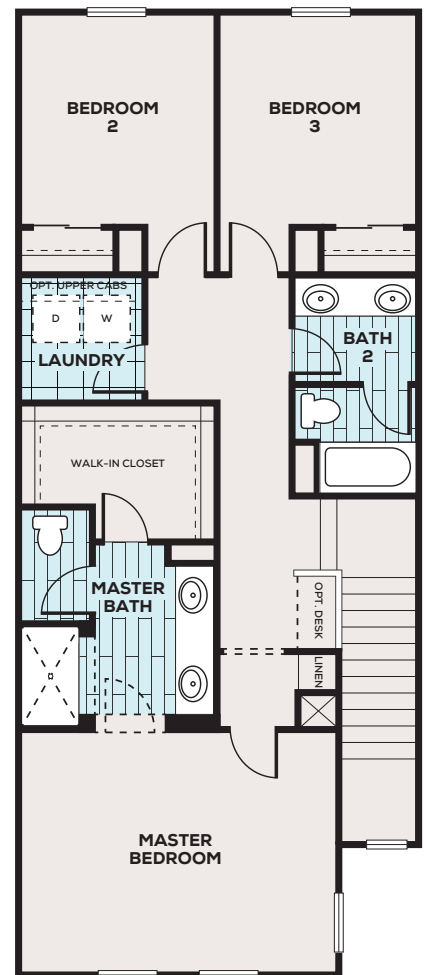

THIRD FLOOR



In a continuous effort to improve our product, Blue Mountain reserves the right to make changes or modifications to pricing, standard features, options & other building specifications & dimensions without prior notice. Please see sales representative for details. Square footage is approximate based upon design. 08.22.19

BLUE MOUNTAIN  
COMMUNITIES





In a continuous effort to improve our product, Blue Mountain reserves the right to make changes or modifications to pricing, standard features, options & other building specifications & dimensions without prior notice. Please see sales representative for details. Square footage is approximate based upon design. 08.22.19

BLUE MOUNTAIN  
COMMUNITIES